

111

POETSTROMMEL / TUMBLING SECTION

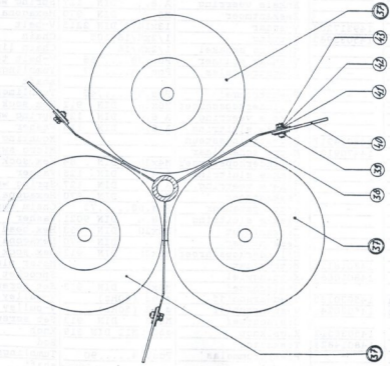

POWER MASTER

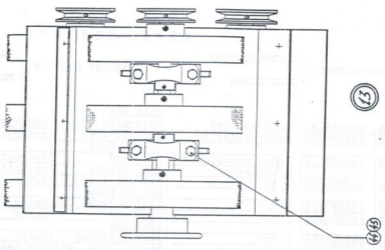

POWER MASTER

POETSTROMMEL $\left\{ \begin{array}{l} \text{HANDBEDIENING} \\ \text{ELECTRISCH} \end{array} \right.$

TUMBLING SECTION $\left\{ \begin{array}{l} \text{HANDROTATION} \\ \text{ELECTRICALLY} \end{array} \right.$

| POS. | ARTIKELNO. | OMSCHRIJVING | ALGEMEEN UNIVERSAL | DESCRIPTION |
|------|------------|------------------------|--------------------------|-------------------------|
| 37 | - | Poetseenheid | Pos.47, ..., 56 | Brush unit |
| 38 | 138010619 | Montage freem | | Mounting frame |
| 39 | 138010668 | Bevestigingsstrip | | Mounting strip |
| 40 | 148014909 | Flapafdichting | | Slapcovering |
| 41 | | Vlakke sluitring | A 5,3 DIN 9021 | Washer |
| 42 | | Enkele veerring | A 5,1 DIN 127 | Spring washer |
| 43 | | Zeskantbout | M5x16 DIN 933 | Hex.head bolt |
| 44 | | Cilinderkopschroef | M10x20 DIN 912 | Hex.sock.headscrew |
| 45 | | Enkele veerring | A 10,2 DIN 127 | Spring washer |
| 46 | | - | - | - |
| 47 | 200945009 | Lappenschijf | φ 240x40 | Mcp |
| 48a | 200975501 | Borstel "bruin" | φ 240x40 | Brush "brown" |
| 48b | 200975706 | Borstel "grijs" | φ 240x40 | Brush "gray" |
| 48c | 200975900 | Borstel "zwart" | φ 240x40 | Brush "black" |
| 49 | 141134089 | Bevestigingsflens | | Mounting flange |
| 50 | | Plat verz.houtsch. | 5x30 DIN 97 | Wood screw |
| 51 | | Stelschroef | M8x20 DIN 913 | Set screw |
| 52 | 145030113 | Bevestigingsas | | Mounting shaft |
| 53 | 145030091 | Kogellager + huis | RPB 20 INA | Ball bearing + housing |
| 54 | 145030121 | V-snaarschijf | | V-pulley |
| 55 | 200990020 | Lederschijf | φ 200 | Leather wheel |
| 56 | OPTIONAL | Couliëskegel | gat "φ 20" bore | Step iron |
| 57 | | - | - | - |
| 58 | 145030571 | Trekveer | Dm8,5;d2:L70 | Pull spring |
| 59 | 148014836 | Spanhevel | | Tensioner arm |
| 60 | | Schotelveer | 28x12,2x1,25 DIN 2093 | Disc spring |
| 61 | 145030300 | V-snaarschijf | | V-pulley |
| 62 | 148014925 | Afstandschijf | | Distance bush |
| 63 | | Zeskantbout | M10x40 DIN 931 | Hex.head bolt |
| 64 | | Vlakke sluitring | A 10,5 DIN 9021 | Washer |
| 65 | | Zekeringsring-gat | 47x1,75 DIN 472 | Retainingring-bore |
| 66 | 142020419 | Kogellager | 6204 LLU N.T.N. | Ball bearing |
| 67 | | - | - | - |
| 68 | 148001602 | Kettingwiel + lager | 73,14x7,2;z=18 | Chainwheel + bearing |
| 69 | | Vlakke sluitring | A 17 DIN 125 | Washer |
| 70 | | Enkele veerring | A 16,2 DIN 127 | Spring washer |
| 71 | | Zeskantmoer | M16 DIN 970 | Hexagonal nut |
| 72 | 138010676 | Spansteun | | Tensioner bracket |
| 73 | | - | - | - |

POETSTROMMEL ONDERDELEN
TUMBLING SECTION PARTS

POWER MASTER

JJ

37

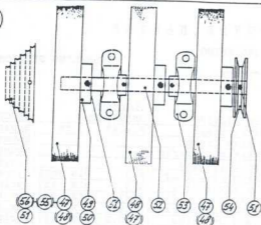

KETTINGSPANNER
CHAIN TENSIONER

23

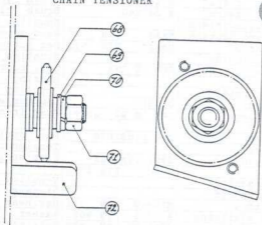

11

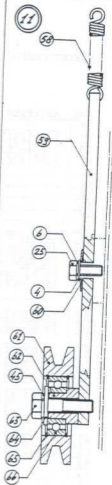

KK

POWER MASTER

POETSTROMMEL {
 HANDBEDIENING
 ELECTRISCH

TUMBLING SECTION {
 HANDROTATION
 ELECTRICALLY

| POS. | ARTIKELNO. | OMSCHRIJVING | ALGEMEEN UNIVERSAL | DESCRIPTION |
|------|------------|---------------------|--------------------------|------------------------|
| 37 | - | Poetseenheid | Pos.47,....56 | Brush unit |
| 38 | 138010619 | Montage freem | | Mounting frame |
| 39 | 138010668 | Bevestigingsstrip | | Mounting strip |
| 40 | 148014909 | Flapafdichting | | Slapcovering |
| 41 | | Vlakke sluitring | A 5,3 DIN 9021 | Washer |
| 42 | | Enkele veerring | A 5,1 DIN 127 | Spring washer |
| 43 | | Zeskantbout | M5x16 DIN 933 | Hex.head bolt |
| 44 | | Cilinderkopschroef | M10x20 DIN 912 | Hex.sock.headscrew |
| 45 | | Enkele veerring | A 10,2 DIN 127 | Spring washer |
| 46 | | - | - | - |
| 47 | 200945009 | Lappenschijf | ø 240x40 | Mop |
| 48a | 200975501 | Borstel "bruin" | ø 240x40 | Brush "brown" |
| 48b | 200975706 | Borstel "grijs" | ø 240x40 | Brush "gray" |
| 48c | 200975900 | Borstel "zwart" | ø 240x40 | Brush "black" |
| 49 | 141134089 | Bevestigingsflens | | Mounting flange |
| 50 | | Plat verz.houtsch. | 5x30 DIN 97 | Wood screw |
| 51 | | Stelschroef | M8x20 DIN 913 | Set screw |
| 52 | 145030113 | Bevestigingsgas | | Mounting shaft |
| 53 | 145030091 | Kogellager + huis | RPB 20 INA | Ball bearing + housing |
| 54 | 145030121 | V-snaarschijf | | V-pulley |
| 55 | 200990020 | Lederschijf | ø 200 | Leather wheel |
| 56 | OPTIONAL | Couliëskegel | gat "ø 20" bore | Step iron |
| 57 | | - | - | - |
| 58 | 145030571 | Trekveer | Dm8,5;d2;L70 | Pull spring |
| 59 | 148014836 | Spannevel | | Tensioner arm |
| 60 | | Schotelveer | 28x12,2x1,25 DIN 2093 | Disc spring |
| 61 | 145030300 | V-snaarschijf | | V-pulley |
| 62 | 148014925 | Afstandschijf | | Distance bush |
| 63 | | Zeskantbout | M10x40 DIN 931 | Hex.head bolt |
| 64 | | Vlakke sluitring | A 10,5 DIN 9021 | Washer |
| 65 | | Zekeringsring-gat | 47x1,75 DIN 472 | Retainingring-bore |
| 66 | 142020419 | Kogellager | 6204 LLU N.T.N. | Ball bearing |
| 67 | | - | - | - |
| 68 | 148001602 | Kettingwiel + lager | 73,14x7,2;z=18 | Chainwheel + bearing |
| 69 | | Vlakke sluitring | A 17 DIN 125 | Washer |
| 70 | | Enkele veerring | A 16,2 DIN 127 | Spring washer |
| 71 | | Zeskantmoer | M16 DIN 970 | Hexagonal nut |
| 72 | 138010676 | Spansteun | | Tensioner bracket |
| 73 | | - | - | - |

45

POETSTROMMEL AS
(ELECTRISCH)

TUMBLING SECTION
SHAFT (ELECTRICAL)

POWER MASTER

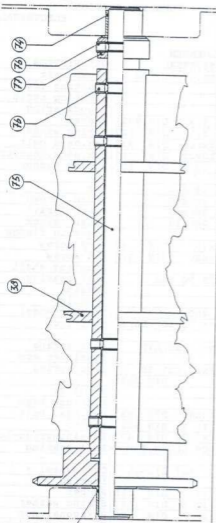

12

POETSTROMMEL AS (HANDBEDIENUNG)
TUMBLING SECTION SHAFT (HANDROTATION)

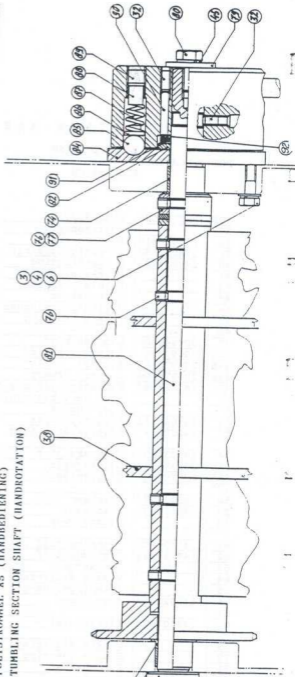

35

MM

P O W E R M A S T E R

POETSTROMMEL { HANDBEDIENING
ELECTRISCH

TUMBLING SECTION { HANDROTATION
ELECTRICALLY

| POS. | ARTIKELNO. | OMSCHRIJVING | ALGEMEEN UNIVERSAL | DESCRIPTION |
|------|------------|--------------------|-------------------------|--------------------|
| 74 | 148001700 | Glijlager "T" | 41/19/25.28.35. 21.1 | Bearingbush "T" |
| 75 | 148014852 | As v.elekt.uitv. | | Shaft electr. |
| 76 | | Stelschroef | M8x10 DIN 913 | Set screw |
| 77 | 148014844 | Stelring | 25x40x16 | Adjusting ring |
| 78 | 148023592 | Vlakke sluitring | 40x10x3 | Washer nylon |
| 79 | 148001866 | Vlakke sluitring | 40x10x4 | Washer STEEL |
| 80 | | Zeskantbout | M10x25 DIN 933 | Hex.head bolt |
| 81 | 148014860 | As v.handbediening | | Shaft handrotation |
| 82 | 148001815 | Friktiering | 44x25x5 | Friction ring |
| 83 | 148023614 | Lagerring | 42x25x3 | Bearing disc |
| 84 | 148023584 | Positioneerschijf | | Positioning disc |
| 85 | 148001904 | Kogel | ø 5/8" | Ball |
| 86 | 148023606 | Veerpositionering | | Spring holder |
| 87 | 148000320 | Drukveer | Dm12,5;d2,5;L22 | Pressure spring |
| 88 | 148001840 | Veerdrager | | Spring holder |
| 89 | 144550903 | Stelschroef | | Set screw |
| 90 | 148001890 | Cilindrische pen | ø6m6x36 DIN 7 | Parallel pin |
| 91 | 145026469 | Schotelveer | 41,6x25,5x0,5 | Disc spring |
| 92 | 148001823 | Vlakke sluitring | 45x25x1 | Washer |

RECHTERDEEL
POWERFINISHER

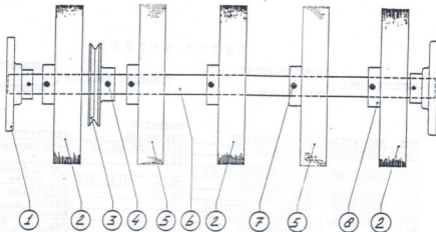

RECHTERDEEL
POWERFINISHER

POETSEENHEID

BRUSH UNIT

| POS. | ARTIKELNO. | OMSCHRIJVING | UNIVERSAL ALGEMEEN | DESCRIPTION |
|------|------------|-------------------|-----------------------|-----------------|
| 1 | 144704722 | Flenslager | UCFA 206 | Bearing flange |
| 2 | 200945009 | Lappenschijf | ø 240x40 | Mop |
| 3 | 144738651 | V-snaarschijf | | V-pulley |
| 4 | | Steelschroef | M8x10 DIN 913 | Set screw |
| 5a | 200975501 | Borstel "bruin" | ø 240x40 | Brush "brown" |
| 5b | 200975706 | Borstel "grijs" | ø 240x40 | Brush "gray" |
| 5c | 200975900 | Borstel "zwart" | ø 240x40 | Brush "black" |
| 6 | 144838605 | Bevestigingsas | | Mounting shaft |
| 7 | 141134100 | Bevestigingsflens | | Mounting flange |

ORTHO FINISHER

OPLAASBARE SCHUURROL.
INFLATABLE SANDING WHEEL
SCHLEIFROLLE/WALZE LUCHTGEFÜLLT

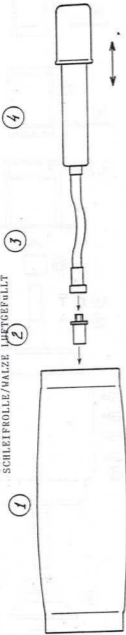

| Pos. | beschrijving | Description |
|------|---|---|
| 1 | Schuurrol 200xø Artno. 144450801 | Scouring/sanding roll Artno. 144450801 |
| 2 | Koperen verloopstuk Artno. 140000275 | Brass adaptor Artno. 140000275 |
| 3 | Slang | Hose |
| 4 | Rechte pomp Artno. 140000283 | Straight pump Artno. 140000283 |
| 5 | Schuurschijf 35xø Artno. 140375902 | Scouring wheel 35xø Artno. 140375902 |
| 6 | Mikkel verloopstuk Artno. 140000268 | Nickelplated adaptor Artno. 140000268 |
| 7 | Haakse pomp Artno. 140000291 | Angled pump Artno. 140000291 |

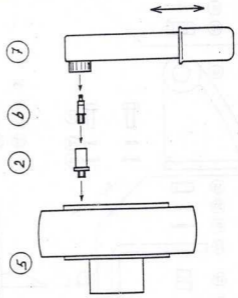

PP

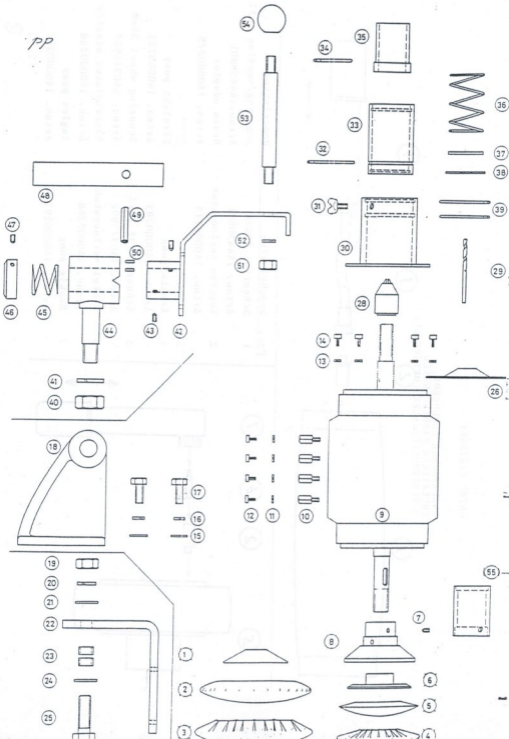

BIMS
NERINAUMKEAG
NERI

| POS. | ARTIKELNO. | OMSCHRIJVING | ALGEMEEN UNIVERSAL | DESCRIPTION |
|------|------------|--------------------|-----------------------|--------------------|
| 1 | 201021315 | Konische dekplaat | | Conical plate |
| 2 | 201021307 | Bimskussen | ø 130 | Naumkeag cushion |
| 3a | 183390628 | Bimskap | ø 130 K 180 | Naumkeag cover |
| 3b | | Bimskap | ø 130 K ... | Naumkeag cover |
| 4a | 183330323 | Bimskap | ø 90 K 60 | Naumkeag cover |
| 4b | | Bimskap | ø 90 K ... | Naumkeag cover |
| 5 | 144705338 | Rubber bimskussen | ø 90 | Naumkeag cushion |
| 6 | 144705451 | Kussenhouder | | Cushion holder |
| 7 | | Stelschroef | M8x10 DIN 915 | Set screw |
| 8 | 144705427 | Bovenkap | | Clamping part |
| 9 | | Motor: | 0,18 kW | Motor: |
| | Aangeven: | 1 of 2 aseinden | Please indicate: | 1 or 2 shaftends |
| 9a | | Een aseinde Kaiser | 220V;1Ph;50Hz | One shaft end |
| 9b | | Een aseinde Kaiser | 220/380/415V-3Ph | One shaft end |
| | | | 50/60Hz | |
| 9c | 144720574 | Twee aseinden Neri | 220/380/415V-3Ph | Two shaft ends |
| | | | 50/60Hz | |
| 9d | 144720582 | Twee aseinden Neri | 220V;1Ph;50/60Hz | Two shaft ends |
| 9e | 145040119 | Een aseinde Kaiser | 220V;1Ph;60Hz | One shaft end |
| 10 | 148000045 | Spec.6 k.schroef | M4x15x9 H1202 | Spec.hex.spacer |
| 11 | | Enkele veerring | A 4,1 DIN 127 | Spring washer |
| 12 | | Cilinderkopschroef | M4x12 DIN 912 | Hex.sock.headscrew |
| 13 | | Enkele veerring | A 5,1 DIN 127 | Spring washer |
| 14 | | Cil.kopschroef | M5x10 DIN 912 | Hex.sock.headscrew |
| 15 | | Vlakke sluitring | A 8,4 DIN 125 | Washer |
| 16 | | Enkele veerring | A 8,1 DIN 127 | Spring washer |
| 17 | | Zeskantbout | M8x30 DIN 933 | Hex.head bolt |
| 18 | 144704862 | Motorsteun | | Naumkeag support |
| 19 | | Zeskantmoer | M12 DIN 970 | Hexagonal nut |
| 20 | | Enkele veerring | A 12,2 DIN 127 | Spring washer |
| 21 | | Vlakke sluitring | A 13 DIN 9021 | Washer |
| 22 | 148019471 | Bevestigingsbeugel | | Mounting bracket |
| 23 | 148000037 | Afstandsbus | polyamide | Distance bush |
| 24 | | Vlakke sluitring | A 13 DIN 9021 | Washer |
| 25 | | Zeskantbout | M12x80 DIN 931 | Hex.head bolt |
| 26 | 148018270 | Afdekplaat | | Cover plate |
| 27 | | | | |
| 28 | 144705265 | Boorkop | | Drillchuck |
| 29 | 200210300 | Boor | ø 3 mm | Drill |
| 30 | 138011168 | Schermhulshouder | | Guard holder |
| 31 | | Vleugelschroef | M6x15 | Wingscrew |
| 32 | 148018351 | Spanring (uitw.) | | Circlip |
| 33 | 148018335 | Schermhulshouder | | Guard holder |
| 34 | 148018378 | Spanring (inw.) | | Circlip |
| 35 | 148018327 | Schermhuis | | Guard |
| 36 | 148018360 | Drukveer | | Coilspring |
| 37 | | Vlakke sluitring | A 23 DIN 125 | Washer |
| 38 | | Zekeringsring-huis | 40x1,75 DIN 472 | Retainingring-hous |
| 39 | 148018343 | Spanring (inw.) | | Circlip |

RR

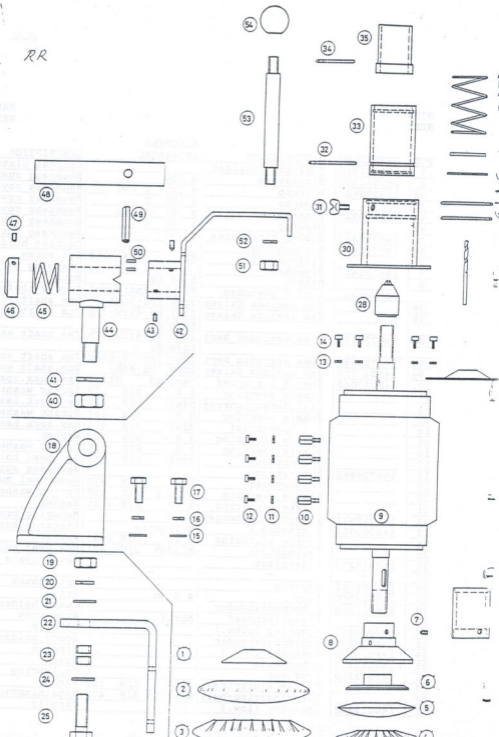

BIMS

| POS. | ARTIKELNO. | OMSCHRIJVING | ALGEMEEN UNIVERSAL | DESCRIPTION |
|------|------------|--------------------|-----------------------|-----------------------------|
| 40 | | Zeskantmoer | M16 DIN 970 | Hexagonal nut |
| 41 | | Enkele veerring | A 16,2 DIN 127 | Spring washer |
| 42 | 138011141 | Bevestigingsbeugel | | Mounting bracket |
| 43 | | Stelschroef | M6x8 DIN 914 | Set screw |
| 44 | 144704919 | Bevestigingsbus | | Pivoting holder |
| 45 | 144705036 | Drukveer | | Coilspring |
| 46 | 144705044 | Steiring | A 25 DIN 705 | Adjusting ring |
| 47 | | Stelschroef | M8x6 DIN 913 | Set screw |
| 48 | 148018440 | Ophangas | | Mounting shaft |
| 49 | | SpiraaIsplanbus | 8x40 DIN 7343 | Spring type straight pin |
| 50 | | SpiraaIsplanbus | 4x20 DIN 7343 | Spr.type straight pin |
| 51 | | Zeskantmoer | M10 DIN 970 | Hexagonal nut |
| 52 | | Enkele veerring | A 10.2 DIN 127 | Spring washer |
| 53 | 148018319 | Handgreep (motor) | | Handle (motor) |
| 54 | 144700549 | Kogelknop | M10x30 DIN 319 | Knob |
| 55 | 148019498 | Beveiligingsbus | only for GB | Perspex safetybus |

77

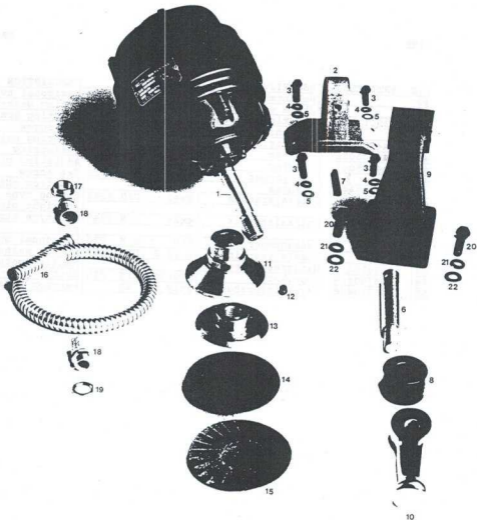

BIMSMOTOR KAISER

| Ref.Nr. | Code Nr. | Omschrijving |
|---------|-----------|--|
| 1 | 145040011 | Bismotor 220/380V-50Hz 1 assig z.schakelaar |
| 2 | | Houder bismotor |
| 3 | | Tapbout M6x25 DIN 933 |
| 4 | | Veerring M6 |
| 5 | | Sluitring M6 |
| 6 | 145040127 | Ophangas |
| 7 | | Spanstift \varnothing 6x50 |
| 8 | 145040259 | Afstandsring |
| 9 | 144704862 | Steun bismotor |
| 10 | 145040232 | Vaszethevel |
| 11 | 144705427 | Bovenkap bims |
| 12 | | Stelschroef M8x6 punt |
| 13 | 144705451 | Kussenhouder bims |
| 14 | 144705338 | Bimskussenrubber |
| 15 | 183330323 | Bimskapje 90mm K60 |
| 16 | 144706962 | Metalenbeschermingslang |
| 17 | 144706806 | Verloopring PG 13,5/Pg 9 |
| 18 | 144706946 | Wartel PG 9 voor beschermingslang |
| 19 | 144706954 | Moer PG 9 |
| 20 | | Tapbout M8x30 |
| 21 | | Veerring M8 |
| 22 | | Sluitring M8 |

UU

VV

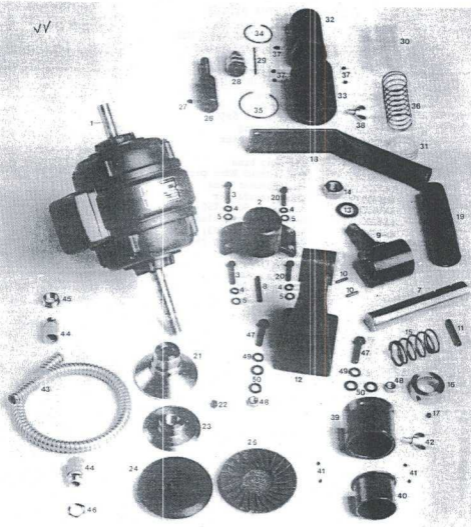

| REF.NR. | CODE NR. | OMSCHRIJVING |
|---------|-------------|--|
| 1. | 144.720.558 | BIMSMOTOR 220/380 V 50 HZ 205519 Z.SCHAKELAAR |
| 2. | | HOUDER BIMSMOTOR |
| 3. | | TAPBOUT M6.25 DIN 933 |
| 4. | | VEERING M6 |
| 5. | | SLUITRING M6 |
| 7. | 144.705.010 | OPHANGAS |
| 8. | | SPANSTIFT @ 6x50 |
| 9. | 144.704.919 | BEVESTIGINGSBUS |
| 10. | | SPANSTIFT @ 4x20 |
| 11. | | SPANSTIFT @ 8x40 |
| 12. | 144.704.862 | STEUN VOOR BIMSMOTOR |
| 13. | | SLUITRING M16 |
| 14. | | MOER M16 |
| 15. | 144.705.036 | DRUKVEER BIMSGELEIDER |
| 16. | 144.705.044 | STELRING 25x40x16 |
| 17. | | STELSCHROEF M8x6 |
| 18. | 144.705.117 | HANDEL VOOR BIMSMOTOR |
| 19. | 144.705.150 | HANDVAT |
| 20. | | TAPBOUT M6x30 |
| 21. | 144.705.427 | BOVENKAP BIMS |
| 22. | | STELSCHROEF M8x6 PUNT |
| 23. | 144.705.451 | KUSSENHOUDER BIMS |
| 24. | 144.705.338 | BIMSKUSSEN RUBBER |
| 25. | 183.330.323 | BIMSKAPJE 90MM K.60 |
| 26. | 144.705.206 | BOORKOPKOUDEUR |
| 27. | | STELSCHROEF M6x5 |
| 28. | 144.705.265 | BOORKOP |
| 29. | | BOOR 3 MM |
| 30. | 144.705.532 | SCHUIFBARE BESCHERMKOKER P.13533 |
| 31. | 144.705.575 | VEER OPSLUITING P.13537 |
| 32. | 144.705.524 | VERSTELBARE BESCHERMKOKER P.13532 |
| 33. | 144.705.516 | BUITENSTE BESCHERMKOKER P.13531 |
| 34. | 144.705.559 | BORGVEER D=2,5 P.13535 |
| 35. | 144.705.567 | BORGVEER D=2,5 P.13536 |
| 36. | 144.705.540 | DRUKVEER P.13534 |
| 37. | | STELSCHROEF M5x6 DIN 914 |
| 38. | | VLEUGELSCHROEF M6x15 DIN 316 |
| 39. | 144.705.435 | SCHERMKAP BIMS |
| 40. | 144.705.435 | SCHERMKAP BIMS |
| 41. | | STELSCHROEF M4x |
| 42. | | VLEUGELSCHROEF |
| 43. | 144.706.962 | METALEN BESCHERMSLANG D.4 M1R |
| 44. | 144.706.946 | WARTEL PG.9 V.BESCHERMSLANG |
| 45. | 144.706.806 | VERLOOPRING PG.13,5-PG.9 |
| 46. | 144.706.954 | MOER PG.9 |
| 47. | | TAPBOUT M8x30 DIN 934 |
| 48. | | MOER M8 |

XX

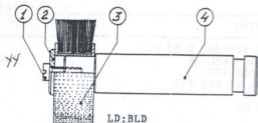

LD:BLD

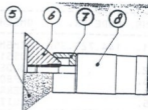

RD

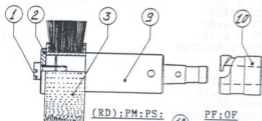

(RD);PM;PS;

PF;OF

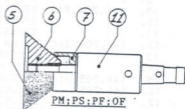

PM;PS;PF;OF

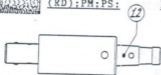

12

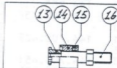

Groefmes frais
Groove trimmer

ONDERDELEN

PARTS

| POS. | ARTIKELNO. | OMSCHRIJVING | ALGEMEEN UNIVERSAL | DESCRIPTION |
|------|------------|---------------------------|-----------------------|----------------------------|
| 1 | 144701014 | linkse schroef | | Left screw |
| 2 | 143807404 | Vlakte sluitring | | Washer |
| 3a | 203803426 | Stalen borstel | ø 80 | Wire brush |
| 3b | 200960008 | Nylon borstel | ø115 | Nylon brush |
| 4 | 144700956 | As | | Shaft |
| 5a | 185103030 | Schuurkap | ø 60 | Sand cap |
| 6 | 144739917 | Kontaktkegel | | Contact cone |
| 7 | 144704579 | Klembus | | Vise tube |
| 8 | 144739259 | As | | Shaft |
| 9 | 145010627 | Bajonetas | | Bajonet shaft |
| 10 | 145010210 | Bajonetadaptor | | Bajonet adaptor |
| 11 | 145010244 | Bajonetas | | Bajonet shaft |
| 12 | 201150808 | SPECIAL: Coulieshouder | | SPECIAL: Coulies holder |
| 13 | 202070000 | Groefmes | | Groove trimmer |
| 14 | 202075001 | Afstelbus | | Adjusting bush |
| 15 | | Stelschroef | M4x4 DIN 913 | Set screw |
| 16a | 202070808 | As | M8 L | Shaft |

A1

- 11
- 12
- 13
- 14
- 15

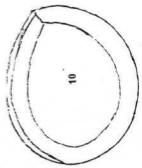
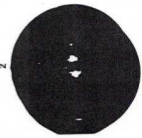
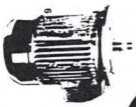

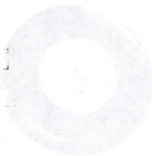

CI

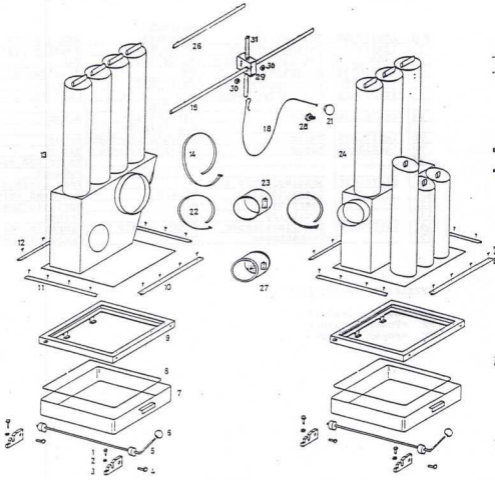

POWER MASTER/POWER STAR/POWER FINISHER/ORTHO FINISHER/RECHTERDEEL

STOFZUIGER

DUST EXTRACTOR SECTION

| POS. | ARTIKELNO. | OMSCHRIJVING | ALGEMEEN UNIVERSAL | DESCRIPTION |
|------|------------|--------------------|-----------------------|----------------------------|
| 1 | 138013799 | Stofzuigerhuis | PM/PF/RDII | Housing dust extr. |
| 2 | 148001505 | Ventilatorwaaier | PM/PF/RDII | Fan |
| 3 | 148010342 | Motorplaat | PM | Mounting pl. motor |
| 4 | 148010350 | Instroomtrechter | PM/PF/RDII | Venturi |
| | 132004518 | Stofzuiger compl. | Pos.1, . . . , 4 | Dust extr. assembly |
| | | | PM/PF/RD | |
| 9a | 144701294 | Motor | 220/380/415 | Motor |
| | | | 3Ph-50/60Hz | |
| 9b | 145170659 | Motor | 220/240-1Ph-50Hz | Motor |
| 9c | 144720264 | Motor | 208/220-1Ph-60Hz | Motor |
| 9d | | | | Motor CSA spec. on request |
| 10 | 144701421 | Schuimplastic afd. | | Foam plastic seal |
| 11 | | Zeskantbout | M10x20 | Hex. head bolt |
| 12 | | Veerring | M10 | Springlockwasher |
| 13 | | Sluitring | M10 | Washer |
| 14 | 144700328 | Trillingsdemper | 50x30 1xM10 | Vibration damper |
| 15 | | Zeskantmoer | M10 | Hexagonal nut |

VERKLARING AFKORTINGEN

RDII=Rechterdeel II
 PF =Power Finisher
 PM =Power Master

148 89118

D1

POWER MASTER/POWER STAR/POWER FINISHER/ORTHO FINISHER/RECHTERDEEL.

| Stoffilter systeem | | | Dust Filter system | |
|--------------------|------------|-------------------|--------------------------------|---------------------------------------|
| POS | ARTIKELNO. | OMSCHRIJVING | ALGEMEEN UNIVERSAL | DESCRIPTION |
| 1: | | Verzonken schroef | M6x45 Din 963 | Slotted counter-sunk screw |
| 2: | | Zeskantmoer | M6 Din 934(970) | Hexagonal nut |
| 3: | 144701162 | Steipal | | Adjuster |
| 4: | | Zeskantbout | M8x30 Din 931 | Hex.head bolt |
| 5: | 144701200 | Spanarm | | Lever |
| 6: | 144700549 | Kogelknopmoer | CM10xØ32 Din 931 | Knob |
| 7: | 138011966 | Stoflade | | Dust drawer |
| 8: | 144700239 | Klemafdichting | 10.2x20.5 | Seal dustdrawer |
| 9: | 145000133 | Klemframe | | Fixing frame dust-filter |
| 10: | 145000168 | Klemstrip | | Clamping strip |
| 11: | 144701251 | Klemstrip | | Clamping strip |
| 12: | | Zeskant kraagbout | St-4.8x13 Din 7504 K | Seldril.hex.head screw with collar |
| 13: | 148010369 | Stoffilter Links | P.STAR/MASTER/ FINISHER/RD. | Dustfilter bag |
| 14: | | Klemband lang | 120 cm. | Fixing belt |
| 15: | 148024777 | Schudas | PM/PF/RD | Shaking bar |
| 18: | 144701367 | Staalkabel | | Steelwire |
| 21: | 144701413 | Paddestoelknop | M10xØ50 | Mushroom knob |
| 22: | 144701278 | Klemband | 90 cm. | Fixing belt |
| 23: | 138013837 | Aansluitring | Alleen/only for PM/PF/RD/ | Filter connector |
| 24: | 148010377 | Stoffilter rechts | Alleen/only for PM/PF/RD | Dustfilter bag |
| 25: | | Lage zeskantmoer | M10 Din 439B | Hexagonal nut-low |
| 26: | 138013748 | Schudas | Alleen/only for Power Star | Shaking bar |
| 27: | 138013594 | Afdichtkap | Alleen/only for Power Star | Filter cover |
| 28: | | Zeskantbout | M10x30 Din 921 | Hex.head bolt |
| 29: | 1487024785 | Kunststof blok | | Nylon block |
| 30: | | Snelborger ring | Ø 16 | Fixing washer |

Power
SCHOENMACHINES

UTRECHT THE NETHERLANDS
☎ 030-615271 FAX 030-618214
TELEX 70075

POWER

MASTER II

POWERTRONIC CONTROL

FRONT-
STICKER

←

WAARSCHUWING
VOOR OPENEN STROOM-
TOEGANG AFGEPITTELEN



WARNING
DISCONNECT POWER SUPPLY
BEFORE OPENING



ACHTING
BEVOR OPENEN HAUPTSTROM-
ANSCHLUSSES ABGESCHALTET



ATTENTION
COMPTER L'ALIMENTATION
AVANT D'OUVRIR



POWERTRONIC CONTROL



MEMBRAUE SWITCH
MEMBRAAN SCHAKELAAR
FOLIENSTATUR

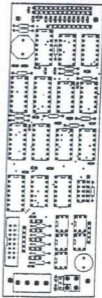

POWERTRONIC CONTROLPANEEL
POWERTRONIC BEDIENINGSPANEEL
POWERTRONIC STEUERUNG

RECHTERDEEL

POWER MASTER

POWER STAR

ORTHOP FINISHER

POWER FINISHER



FLATCABLE
BAND KABEL

OVERLOAD SWITCH
MOTOR BEVEELIGINGS SCHAKELAAR
MOTOR SCHUTZSCHALTER

TRANSFORMER
TRANSFORMATOR

MAGNET SWITCH
MAGNEET SCHAKELAAR
MAGNET SCHALTER

FUSE
ZEKERING
SICHERUNG

PRINTED CIRCUITBOARD COMPL.
GEDRUKTE SCHAKELING COMPL.

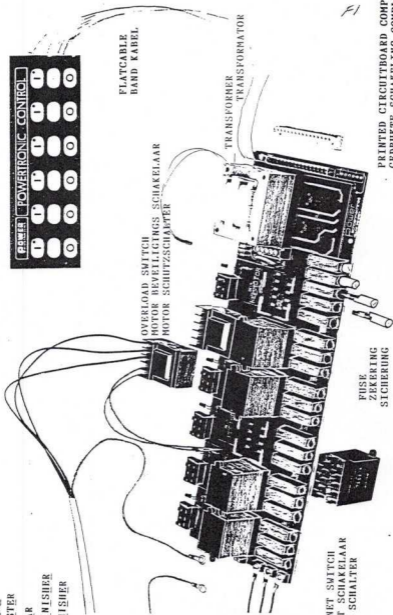

F1

RESEARCH DEPARTMENT COMBAT
ARMIES DISSEMINATED COMBAT

RESEARCHING
SYSTEMS
LINE

RESEARCH DEPARTMENT
COMBAT ARMIES DISSEMINATED
COMBAT

RESEARCH DEPARTMENT
COMBAT ARMIES DISSEMINATED
COMBAT

RESEARCH DEPARTMENT
COMBAT ARMIES DISSEMINATED
COMBAT

RESEARCH DEPARTMENT
COMBAT ARMIES DISSEMINATED
COMBAT



RESEARCH DEPARTMENT
COMBAT ARMIES DISSEMINATED
COMBAT